

State of Oklahoma American Rescue Plan Act

Joint Committee on Pandemic Relief Funding

December 6, 2021

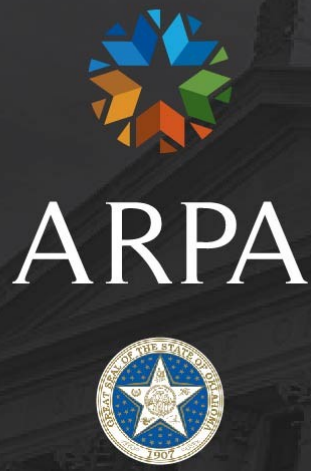



AGENDA

- Opening Remarks from the Chairs
- Discussion and possible action on Working Group recommendations
- Non-Entitlement Units (NEU) Stats
- Intake Stats
- Follow up items
- Other business
- Closing Discussion and Remarks from the Chairs



ARPA

Opening Remarks from the Chairs





ARPA

Discussion and possible action on Working Group recommendations



Working Group Recommendation

- ▶ Transportation, Infrastructure, & Rural Development
- ▶ Broadband Mapping (Oklahoma Department of Commerce)



ARPA



Working Group Recommendation

➤ Health & Human Services

➤ Pediatric Behavioral Health
Emergency Department (University
Hospitals Authority)



ARPA





ARPA

Non-Entitlement Units (NEU) Stats



NEU Status Update

579 NEUs in the State of Oklahoma
\$119M available to NEUs in the first tranche

543 NEUs **received** a **login** to the portal
(~94% of NEUs)

341 NEUs **signed up** and **accepted funds**
(~59% of NEUs)

246 NEUs with ARPA funds **in their accounts**
(~42% of NEUs)

\$100 **Million dollars distributed**
(~84% of total funding for first tranche)

Next Steps

- Personalized outreach to remaining 238 NEUs which **have not** accepted funds
 - *Postcards*
 - *Door-to-door*
 - *Senator/Representative outreach*
- Payment processing for 95 NEUs which **have** accepted funds
 - *2 weeks until completion*
 - *~\$15 M in total payments*
- US Treasury extension request submission due 1/2/21
- Monthly US Treasury eligibility and expenditure report due 12/31



NEU Status Update

579 NEUs in the State of Oklahoma

\$119M available to NEUs in the first tranche

OK NEU - Tranche 1 Counts and Funds Breakdown

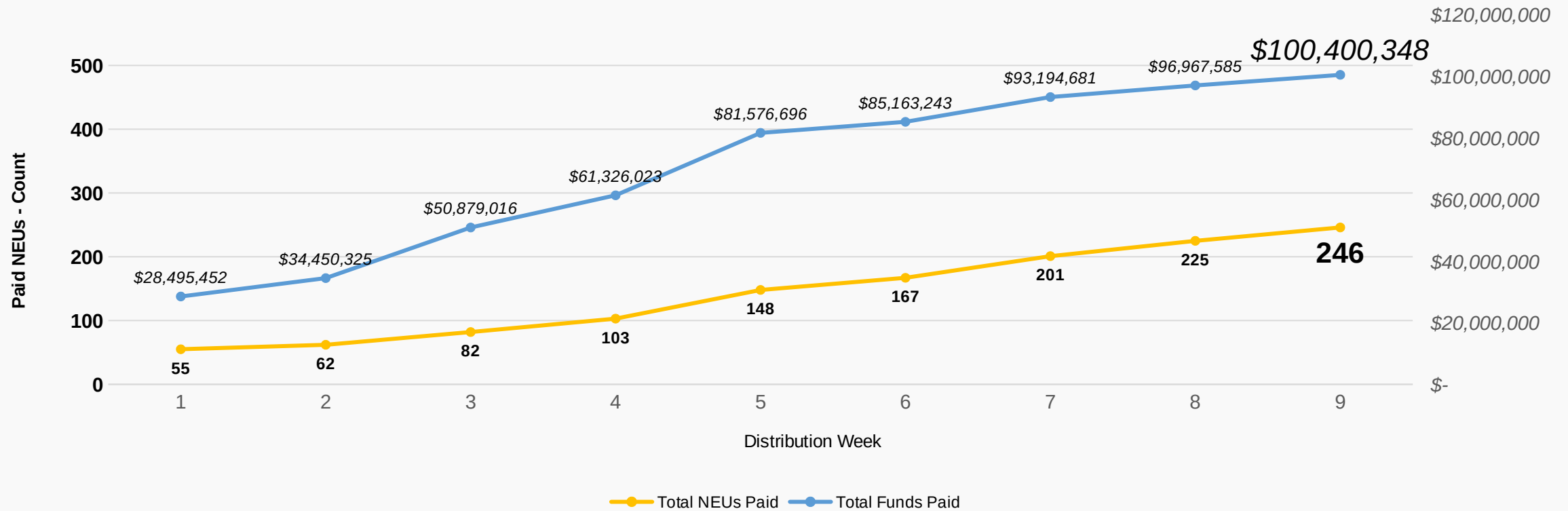



ARPA

Intake Stats



Intake Form Statistics

Submissions through 12/3



83 Ideas Submitted

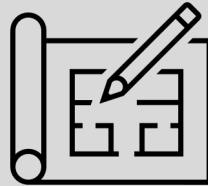

388 Projects Submitted

Eligible Use	Ideas	Projects	Funds Request
Public Health Expenditures	18	79	\$1.4 B
Addressing Negative Economic Impacts	34	212	\$3.0 B
Lost Public Sector Revenue	6	20	\$522.6 M
Premium Pay for Essential Workers	6	11	\$314.6 M
Investments in Water, Sewer, and Broadband	19	66	\$1.7 B
TOTAL	83	388	\$7.0 B

Highest dollar amount: **\$350 M**

Lowest dollar amount: **\$17 K**

Entity Type	Ideas	Projects
Small 501-C3 Nonprofit	20	40
Large 501-C3 Nonprofit	17	69
Other Nonprofit Entity	4	40
State Agency	12	169
Municipal Government Entity	10	23
County Government Entity	2	7
Small Business	6	25
Other Business Entity	3	11
Oklahoma Resident	8	4
Total	83	388





ARPA

Follow up items



Follow-Up Items from September 22 meeting

Action Items Log

Request	Description	Status
Required Programmatic Indicators	Treasury guidance regarding the required programmatic performance indicators for the Recovery Plan	Sent to Joint Committee members (10/1/21)



Follow-Up Items from September 8 meeting

Action Items Log

Request	Description	Status
Qualified Census Tracts	Map of Qualified Census Tracts	Sent to Joint Committee members (10/4/21)
Premium Pay	One pager: Overview of Premium Pay requirements and allowable uses	Sent to Joint Committee members (10/4/21)
Interim Final Rule Vulnerable Populations	One pager: Overview of Interim Final Rule requirements regarding vulnerable populations	Sent to Joint Committee members (10/4/21)
Engagement Memo	Memo indicating Guidehouse will not pursue any work with Oklahoma cities, counties, municipalities or other local units without prior written consent	Delivered to CFO & Co-Chairs





ARPA

Other business





ARPA

Closing Discussion and Remarks from the Chairs

