

State of Oklahoma American Rescue Plan Act

Joint Committee on Pandemic Relief Funding

October 5, 2021



AGENDA

- Opening Remarks from the Chairs
- Reporting Update and Possible Action on Recovery Plan Performance Report
- Working Groups
 - Economic Development & Workforce
 - Transportation, Infrastructure, & Rural Development
- Non-Entitlement Units (NEU) Status
- Intake Stats
- Follow Up Items
- Closing Discussion and Remarks from the Chairs



ARPA





ARPA

Opening Remarks from the Chairs





ARPA

Reporting Update and Possible Action on Recovery Plan Performance Report



10/11 Reporting Updates

- Interim Report due 10/11
 - Nothing to report
- Recovery Plan Performance Report
 - To be submitted by 10/11 after Full Joint Committee approval
 - Initial report includes overview of Joint Committee and Working Groups governance structures, procedures and processes
 - Future reports will include uses of funds and performance metrics

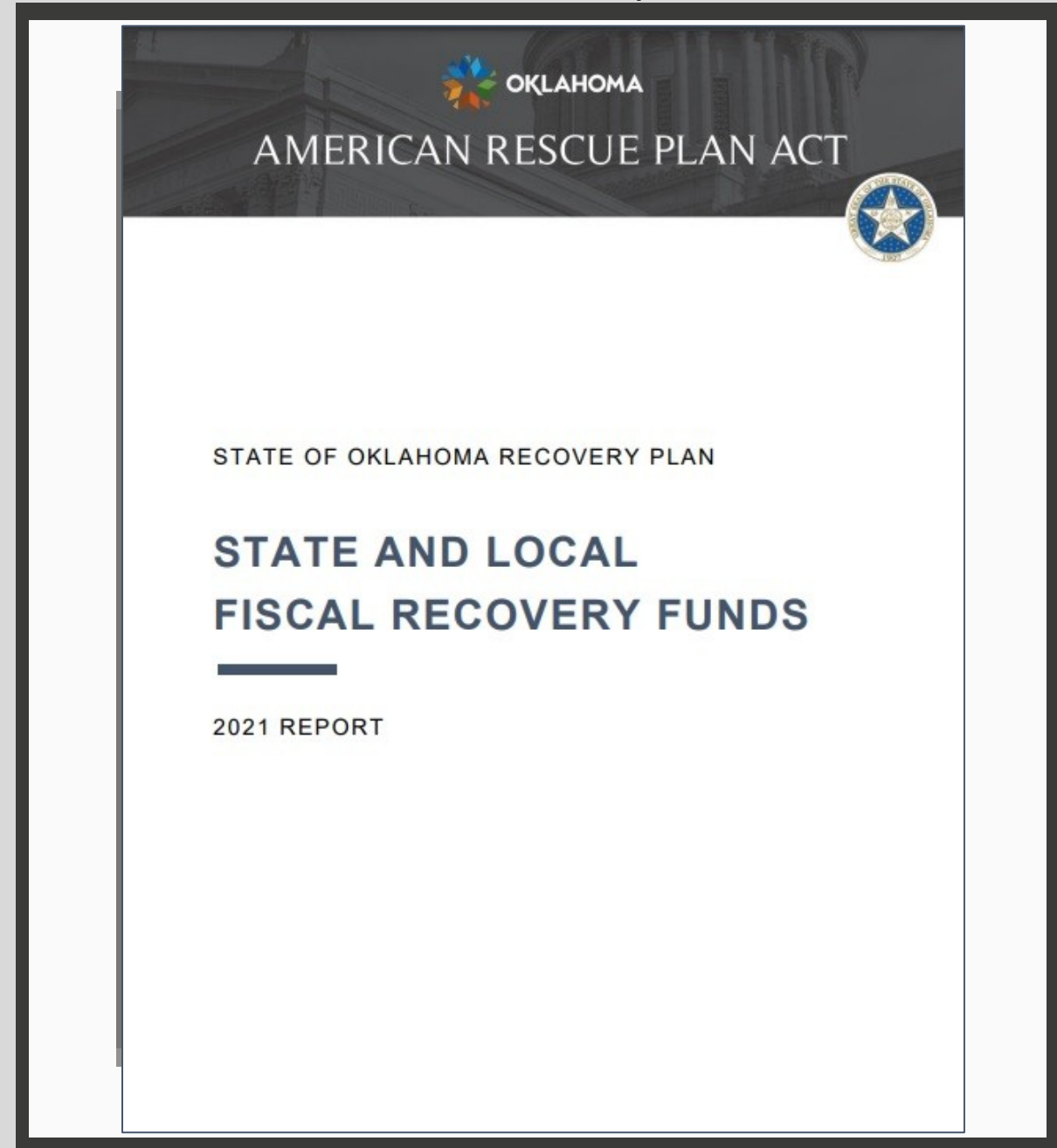



ARPA

Working Groups



Working Groups: Report Out

- ▶ Economic Development & Workforce
- ▶ Speakers: Co-Chairs Pugh & Baker



ARPA



Working Groups: Report Out

- ▶ Transportation, Infrastructure, & Rural Development
- ▶ Speakers: Co-Chairs Leewright & Phillips



ARPA





ARPA

Non-Entitlement Units (NEU) Status



NEU Status Update

325

NEUs have received a login to sign up in the portal

116

NEUs are signed up on the portal and have accepted funds (*No NEUs have declined funds*)

65

NEUs have ARPA funds in their accounts

37

Million dollars distributed to 65 NEUs

Next Steps

- Completion of document verification and payment processing for NEUs signed up in the portal
- Continued communication to NEUs on completing signup
- Scale solution to remaining 250 NEUs





ARPA

Intake Stats



Intake Form Statistics

Submissions through 10/4



4 Ideas Submitted

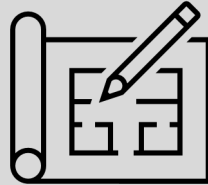

25 Projects Submitted

Eligible Use	Projects	Funds Requested
Public Health Expenditures	2	\$23.9M
Addressing Negative Economic Impacts	13	\$936.9M
Lost Public Sector Revenue	1	\$1.2M
Premium Pay for Essential Workers	1	\$11M
Investments in Water, Sewer, and Broadband	8	\$24.3M

Entity Type	Ideas	Projects
Large 501-C3 Nonprofit	2	4
Small 501-C3 Nonprofit	0	6
Other Nonprofit Entity	0	7
State Agency	0	3
Municipal Government Entity	0	1
County Government Entity	0	0
Small Business	1	3
Other Business Entity	0	1
Oklahoma Resident	1	0



Intake Form: Next Steps



Preliminary Eligibility Review: Develop preliminary eligibility review process and rubric



Phase 2 to build reports: Develop public-facing reporting metrics regarding high-level submission statistics and process flow



Continuous Service Improvement: Evaluate potential improvements to the forms





ARPA

Next Reporting Due 10/31 - Project and Expenditures Report



Project & Expenditures Reporting

- On 9/30, the U.S. Treasury communicated a deadline change for the Project & Expenditures Report
- For states and territories, the report will now be due on **January 31, 2022**
- For non-entitlement units of government (NEUs), the Project and Expenditure report will now be due on **April 30, 2022**



ARPA





ARPA

Follow Up Items



Follow-Up Items from September 22 meeting

Action Items Log

Request	Description	Status
Required Programmatic Indicators	Treasury guidance regarding the required programmatic performance indicators for the Recovery Plan	Sent to Joint Committee members who requested information (10/1)

Follow-Up Items from September 8 meeting

Action Items Log

Request	Description	Status
Qualified Census Tracts	Map of Qualified Census Tracts	Sent to Joint Committee members who requested information (10/4)
Premium Pay	One pager: Overview of Premium Pay requirements and allowable uses	Sent to Joint Committee members who requested information (10/4)
Interim Final Rule Vulnerable Populations	One pager: Overview of Interim Final Rule requirements regarding vulnerable populations	Sent to Joint Committee members who requested information (10/4)
Engagement Memo	Memo indicating Guidehouse will not pursue any work with Oklahoma cities, counties, municipalities or other local units without prior written consent	Delivered to CFO & Co-Chairs





ARPA

Closing Discussion and Remarks from the Chairs

